



Repairing a Wobbly Piano Bench

This guide is to instruct you on how to fix a...

Written By: Davood Dehghani Firoozabadi



INTRODUCTION

This guide is to instruct you on how to fix a wobbly piano bench seat. Fixing this problem would result in a firm and balanced piano bench seat. While, eliminating possible noise coming from the bench as you are seated on it, and give you confidence in the structure of the piano bench seat, to allow you to be focused while playing your piano. There are no specialty skills or tools that are necessary, other than the knowledge of how to use a smart wrench. Following the guide properly, and in the step's order as instructed, should allow for you to repair your wobbly piano bench seat with ease.

TOOLS:

Smart Wrench (1)

Washer (4)

Step 1 — Repairing a Wobbly Piano Bench



- Place the bench on an even surface.

Step 2



- Open and lock its lid. Make sure it stays open during the whole procedure.

Step 3



- Unscrew the outer hex nut from one leg using the wrench and take the lock washer out.

Step 4



- Take the leg out and unscrew the inner hex nut.
- Replace the washers with the new ones and re-screw the hex nut tightly.

Step 5

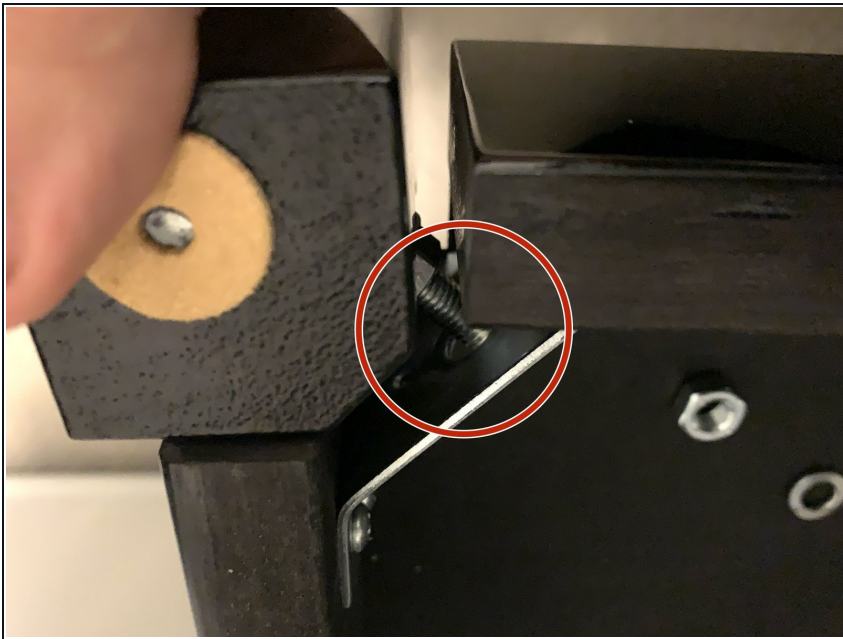

- Connect the leg to the bench again using the new lock washer.
- Screw the hex nut a few rounds, but do not tighten it yet.
- Repeat Steps 3 through 5 for all four legs.

Step 6



- Add a little weight to the chair or push it down with two hands.
- Turn all four outer hex nuts one round.
- Make sure the bench is balanced and repeat until all hex nuts are tight.

Step 7

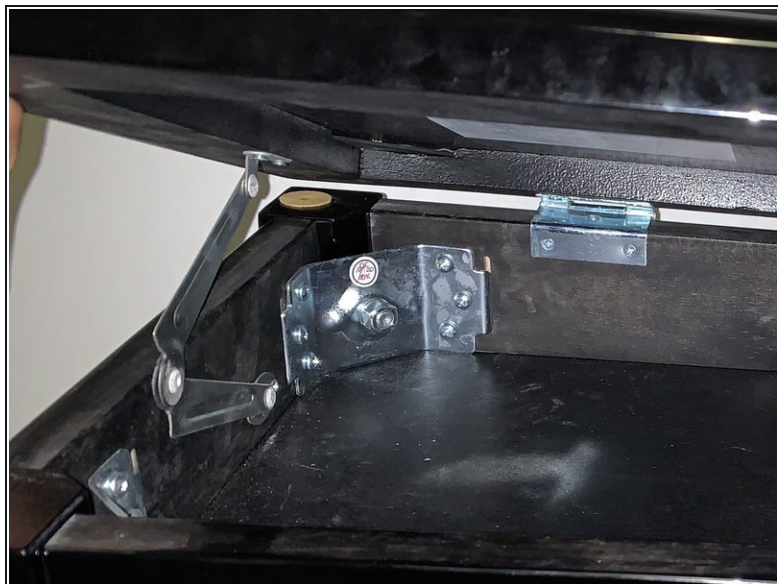

- Close the lid seat on the chair.

ⓘ If the chair is not balanced or if it makes noises, unscrew the outer nut two rounds and repeat Step 6.

You can redo this process every 6 months to make sure your bench is always stable.